

**INSTALLATION INSTRUCTION**  
**LED BOLLARD LIGHT**



## **INTRODUCTION & WARRANTY**

Thank you for selecting and buying V-TAC product. V-TAC will serve you the best. Please read these instructions carefully before starting the installing and keep this manual handy for future reference. If you have any another query, please contact our dealer or local vendor from whom you have purchased the product. They are trained and ready to serve you at the best. The warranty is valid for 2 years from the date of purchase. The warranty does not apply to damage caused by incorrect installation or abnormal wear and tear. The company gives no warranty against damage to any surface due to incorrect removal and installation of the product. The products are suitable for 10-12 Hours Daily operation. Usage of product for 24 Hours a day would void the warranty. This product is warranted for manufacturing defects only.

### **WARNING!**

1. Please turn off power and read this instruction before starting the installation.
2. Install only by certified Electrician.



This marking indicates that this product should not be disposed of with other household wastes.



Caution, risk of electric shock.

## **TECHNICAL SPECIFICATIONS**

Model	Watts	Lumens	Beam Angle	CRI	PF	IP	Body	Dimension
VT-820	10	450	72°	>80	>0.5	IP65	Aluminium	108x800mm
VT-830	10	450	72°	>80	>0.5	IP65	Aluminium	108x250mm

**STRUCTURE**

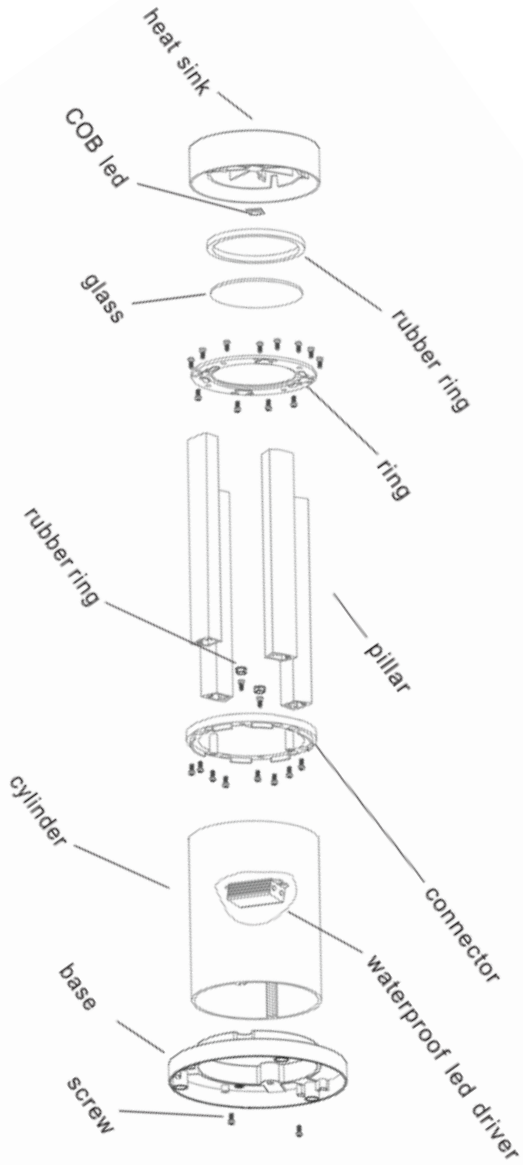

**INSTALLATION INSTRUCTIONS**

1. Switch off the power before installing the lamp.
2. To drill the appropriate holes on the cement floor. (Picture 1)
3. Do the waterproof measure for the wire junction and then Connect the electricity AC:100-240V. (Picture 2)
4. Fix the lamp on the floor by screw. (Picture 3)
5. Cover the nut cap and switch on the power if above steps are done properly without any mistakes. (Picture 4)

