

INSTALLATION INSTRUCTION

VT-8112
LED CABINET LIGHT



!Warning

Turn off power before inspection, installation or removal

Please do not connect the panel directly to 220V. Do not modify the product randomly.

INTRODUCTION

Thank you for selecting and buying V-TAC LED product. V-TAC will serve you the best. Please read these instructions carefully before starting the installing and keep this manual handy for future reference. If you have any other query, please contact our dealer or local vendor from whom you have purchased the product. They are trained and ready to serve you at the best.

PRODUCT INTRODUCTION

This lighting fixture is made with LED diode, which has advantage technology advantage, energy savings, and environmental protection, long life span, saving electricity cost and almost no maintenance time and cost needed. It has 100% efficiency and brighter than any other old fixtures.

PRODUCT OVERVIEW

No maintenance, easy to install, high efficiency, low electricity, power saving, long life span, low temperature and no glare.

TECHNICAL PARAMETERS

Model No:	VT-8112
Power:	10W
Voltage:	AC 200-240V, 50/60Hz
Lumens:	800lm
Beam Angle:	110°
CRI:	>80
PF:	<0.9
Protecting Rating:	IP20
Operating Temperature:	-20°C to +45°C
Unit Size:	
Cut Size:	

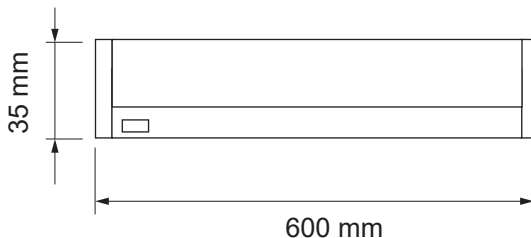

INSTALLATION INSTRUCTIONS

- Install only by qualified electrician.
- Proper grounding should be ensures through installation.
- Do not use with DC wire.

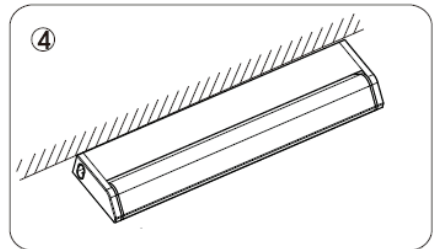
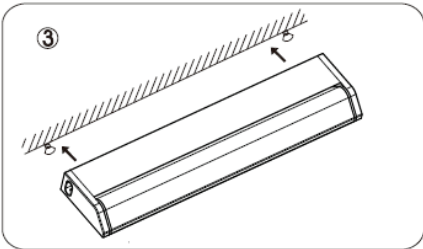
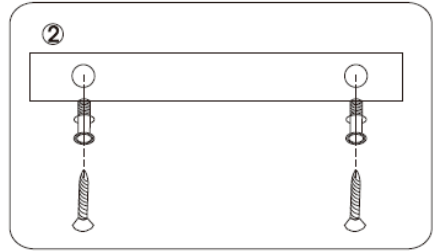
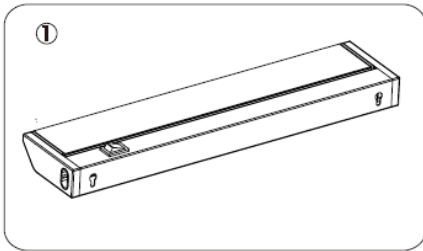

Attention: please check whether the lamp is fixed and wired properly if the lamp doesn't work while switching on.



WARRANTY

- This product is warranty from manufacturing defect only.
- The warranty is valid for 2 years from the date of purchase.
- The warranty does not apply to damage caused by installation or abnormal wear and tear.
- The company gives no warranty against damage to any surface due to incorrect removal and installation of the product.

WARNING

- This is a high-powered LED. As with any light source, direct viewing should be avoided.
- Note: Although easy to fit, this lamp requires wiring to the main and safety should only be fitted by a qualified electrician.
- Having issued this warning, the company accepts no responsibility for issues arising for any failures to comply with these clear instructions.
- The company will not accept any responsibility for any other issues from improper use of fitting of this product as these matters are beyond our control.