

INSTALLATION INSTRUCTION

UNDERGROUND LAMP



8567



8568



8566

2 YEAR
 WARRANTY*

TECHNICAL DATA

Model	Base	Input Power	IP Rating	Dimension	Rated Load
VT-7678-3	MR16 (Bulb not included)	AC/DC:12V	IP67	D:87x128mm	Max 20w
VT-7678-1	MR16 (Bulb not included)	AC/DC:12V	IP67	D:87x128mm	Max 20w
VT-7678-2	MR16 (Bulb not included)	AC/DC:12V	IP67	D:87x128mm	Max 20w

INTRODUCTION & WARRANTY

Thank you for selecting and buying V-TAC Product. V-TAC will serve you the best. Please read these instructions carefully before starting the installing and keep this manual handy for future reference. If you have any another query, please contact our dealer or local vendor from whom you have purchased the product. They are trained and ready to serve you at the best. The warranty is valid for 2 years from the date of purchase. The warranty does not apply to damage caused by incorrect installation or abnormal wear and tear. The company gives no warranty against damage to any surface due to incorrect removal and installation of the product. The products are suitable for 10-12 Hours Daily operation. Usage of product for 24 Hours a day would void the warranty. This product is warranted for manufacturing defects only.

WARNING!

1. Please make sure to turn off the power before starting the installation.
2. The light source of this luminaire is not replaceable, when the light source reaches its end of life the whole luminaire should be replaced.
3. Install only by certified Electrician.



This marking indicates that this product should not be disposed of with other household wastes.

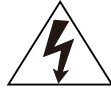

Caution, risk of electric shock.

INSTALLATION DIAGRAM

1. Open the lamp and install the bulb in the lamp
2. Connect the supply leads with terminal (The box not included).
3. Fix the lamp body on the ground.
4. Switch on and test.

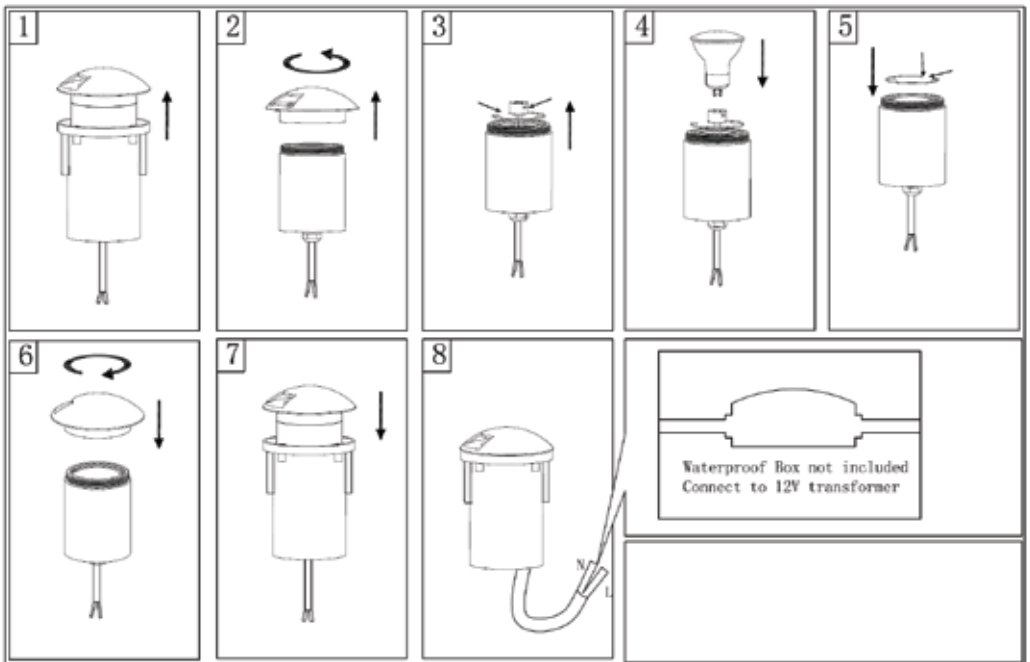

In case of any query/issue with the product please reach out to us at support@vtacexports.com
V-TAC EUROPE LTD, Bulgaria, Plovdiv 4000, bul.L.Karavelow 9B